

UL94V-0.

1500

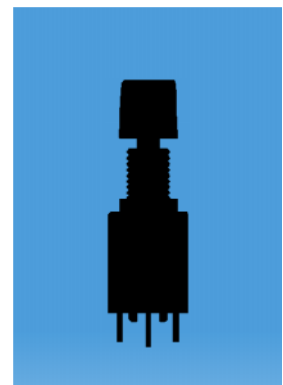
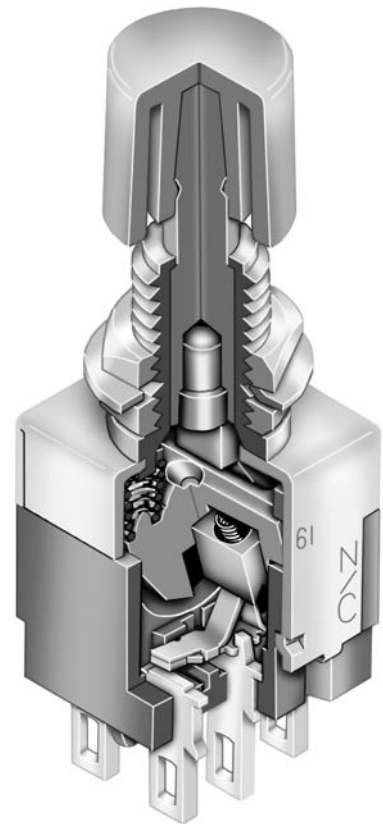

EB20

65

□

B

F

11	SPDT		()
65	SPDT		
61	DPDT		()
85	DPDT		

() =

B	.315" (8.0)
C	.394" (10.0)

G	
P	
PG	

A	
B	
C	
E	
F	
G	
H	



CSA, UL, C-UL

EB2065-BF

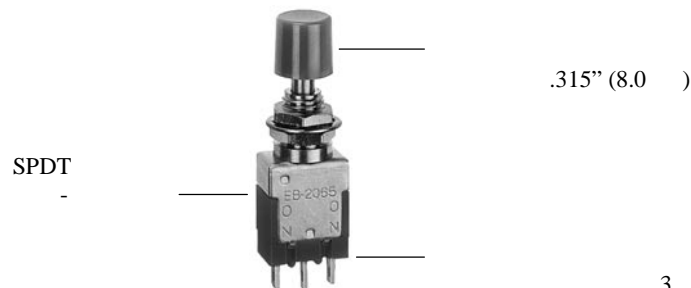

		() =					
SP	EB2011 EB2065		()	2-3	2-1	SPDT	
DP	EB2061 EB2085		()	2-3 5-6	2-1 5-4	DPDT	



3A 125 ()



28

0.4

/

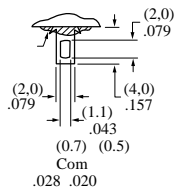

3A 125 ()



0.4

/

28

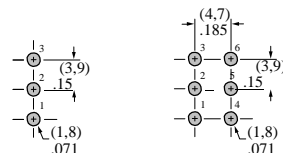
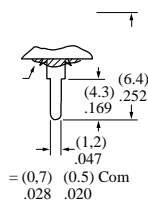

B AT443

8.0

C AT442

10

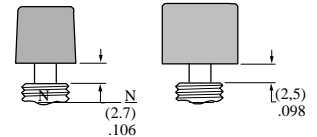
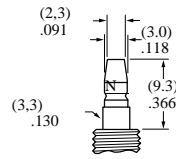
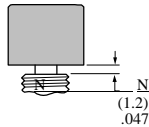
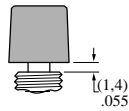
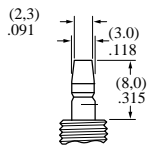
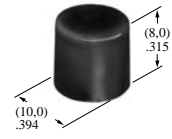
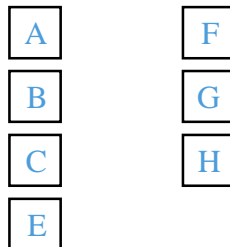
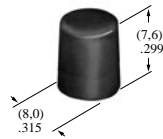
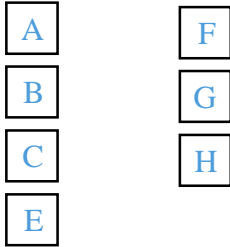

EB2011-BA

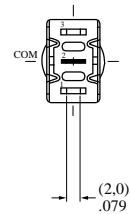
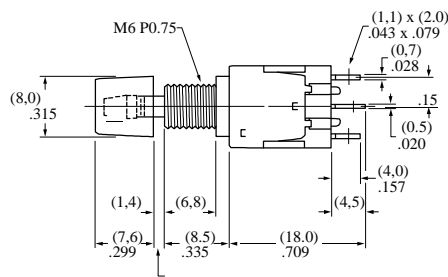
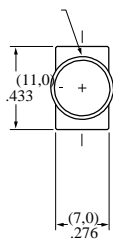

EB2061-BA

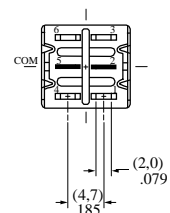
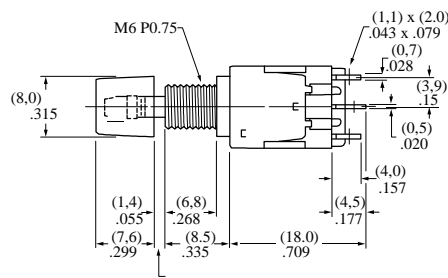
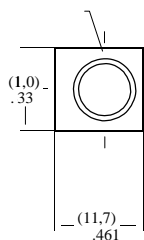

1
AT508

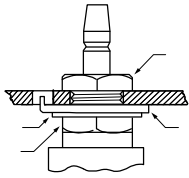

2 AT513M

AT513M

AT509

AT507M

AT507M

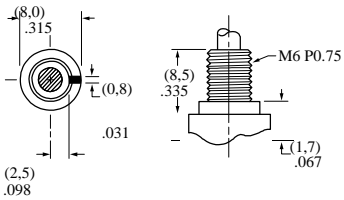
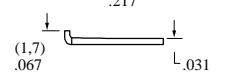
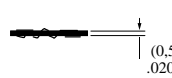
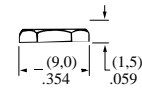
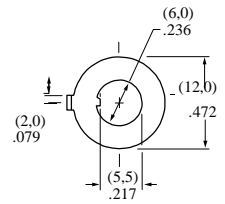
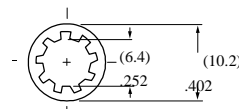
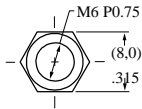

0.118" (3.0)

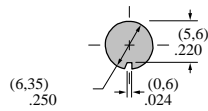

0.055" (2.6)

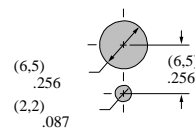

0.185" (4.7)

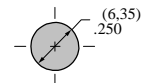

AT442.

" AT512M

AT443, AT512CM